

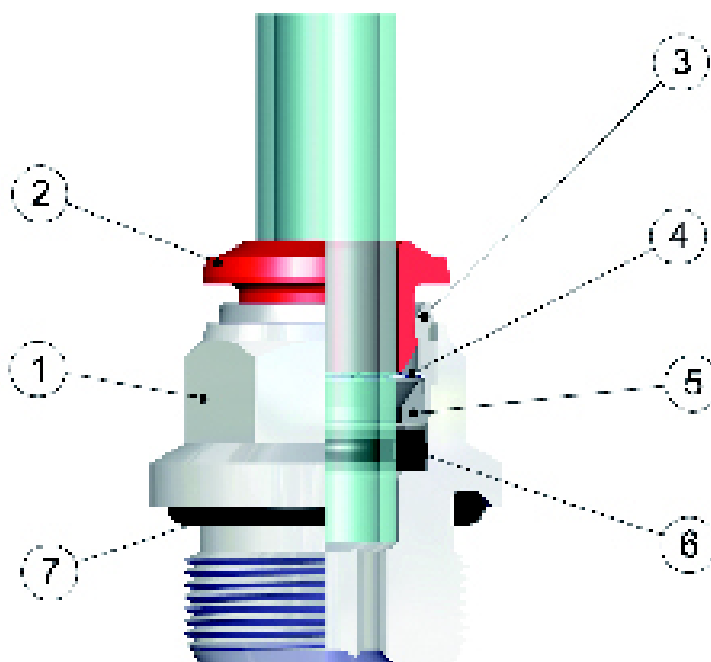

Série 50000

CONEXÕES PUSH-IN
PUSH-IN FITTINGS

Características Técnicas / Technical Characteristics



Materiais e Componentes / Component Parts and Materials

1 Corpo em latão niquelado	1 Nickel-plated brass Body
2 Anilha de liberação do tubo em resina acetálica	2 Acetalic resin Collet
3 Cápsula de latão niquelado	3 Nickel-plated brass Capsule
4 Pinça de travamento em aço-inox aisi 301	4 Steel aisi 301 Clamping washer
5 Anel de segurança em tecnopolímero	5 Technopolymeric Safety ring
6 Vedação em NBR	6 Nbr Lip seal
7 Vedação da rosca em NBR	7 Nbr Thread packing

Pressões / Pressures

Pressão mínima / Minimum pressure: -0.99 bar (-0.099 MPa)
 Pressão máxima / Maximum pressure: 15 bar (1.5 MPa)

Temperaturas / Temperatures

Temperatura mínima / Minimum temperature: -20 °C
 Temperatura máxima / Maximum temperature: +80 °C

Roscas / Threads

Gas cônica "short" / "Short" Tapered thread.
 Gas cônica conforme ISO 7.1, BS 21, DIN 2999 / Tapered gas in conformity with ISO7.1, BS 21, DIN 2999.
 Gas paralela conforme ISO 228 Classe A / Parallel gas in conformity with ISO 228 Class A.
 Métrica conforme ISO R/262 / Metric in conformity with ISO R/262.

Tubos de conexão / Connection Tubes

Tubos em material plástico:
 PA6, PA11, PA12, Polietileno, *Poliuretano, etc.
 *Para tubos em Poliuretano é requerida uma dureza de 98 shore.
 Plastic tubes:
 PA6, PA11, PA12, Polyethylene, *Polyurethane, ecc.
 *For Polyurethane hoses it is required a minimum hardness of 98 shore.

Fluidos compatíveis / Fluids

Ar comprimido / Compressed air.
 Vácuo / Vacuum

Roscas / Threads

A rosca cônica "short" é projetada para satisfazer às seguintes características:

- reduzir o comprimento da conexão
- reduzir o dimensional com relação às roscas paralelas
- permitir o acoplamento da conexão a diferentes tipos de rosca fêmea, sejam elas cônicas ou paralelas

The "short" taper thread has been designed to offer the following advantages to the users:

- reduced overall length;
- smaller hex dimensions compared to the parallel threads;
- to allow the assembly with different female threads both taper as well as parallel;



NPT
NPTF

Cônica
Tapered

ISO 7
BSPP

Paralela
Parallel

ISO 7
BSPT
PT

Cônica
Tapered

ISO 228
BSP
PF
Paralela
Parallel

Permite um aperto correto em superfícies não perfeitamente planas, côncavas, convexas ou inclinadas, com diferentes chanfros ou raios.

To ensure the right tightening also with surfaces not perfectly flat, without spot-facing, concave convex and with different kinds of chamfers or radius.

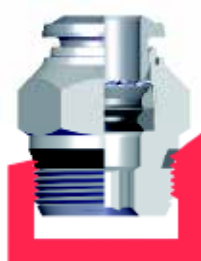

Inclinadas
Inclined



Côncavas
Concave

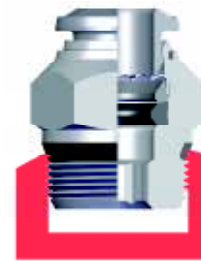

Convexas
Convex

Especificação de torques / Torque specifications



COPPIE DI SERRAGGIO PER FILETTATURE MASCHIO ISO-228 CON OR
TORQUE TO MALE THREADS ISO-228 WITH OR

MISURA MEASURE	COPPIA CONSIGLIATA Nm RECOMMENDED TORQUE Nm	COPPIA DI ROTTURAZIONE Nm BREAKING TORQUE Nm
M5	0,08	0,32
1/8	3	8
1/4	9	30
3/8	10	60
1/2	12	50

I VALORI DI ROTTURAZIONE POSSONO VARIARE IN BASE ALL'ARTICOLO
BREAKING VALUES MAY VARY ACCORDING TO THE ITEM



COPPIE DI SERRAGGIO PER FILETTATURE MASCHIO "SHORT"
TORQUE TO MALE THREADS "SHORT"

MISURA MEASURE	COPPIA MINIMA CONSIGLIATA Nm RECOMMENDED MINIMUM TORQUE Nm	COPPIA MASSIMA CONSIGLIATA Nm RECOMMENDED MAX TORQUE Nm
1/8	5	7
1/4	5	7
3/8	5	7
1/2	5	7

I VALORI DI ROTTURAZIONE POSSONO VARIARE IN BASE ALL'ARTICOLO
BREAKING VALUES MAY VARY ACCORDING TO THE ITEM

Todas as roscas desta série (também no tamanho M5) são dotadas de elementos de vedação, o que permite a imediata utilização das conexões, reduzindo notavelmente o tempo de instalação.
 All of threads from this range (also the M5), have been equipped with tightening parts which allow the direct assembly of the fittings, reducing the installation time.

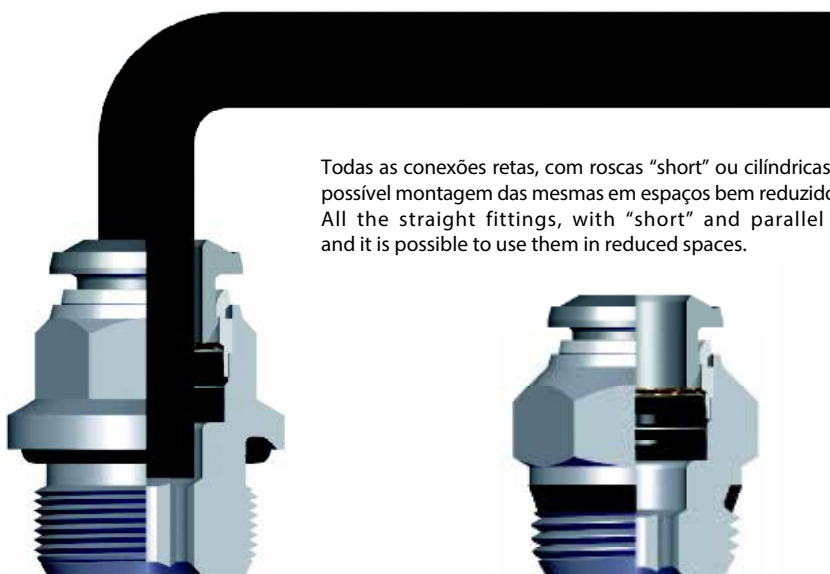
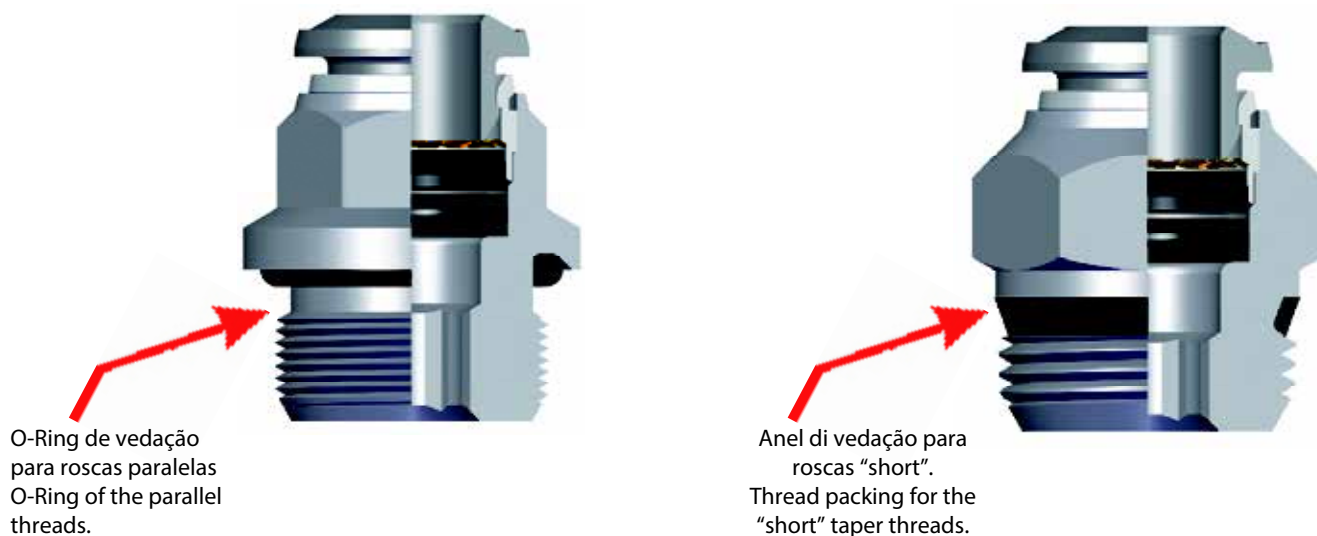

Todas as conexões retas, com roscas "short" ou cilíndricas, podem ser montadas também com chave allen tornando possível montagem das mesmas em espaços bem reduzidos..
 All the straight fittings, with "short" and parallel threads can be assembled also with Allen wrench and it is possible to use them in reduced spaces.

Pinça de travamento / Clamping washer

A pinça em aço-inox garante o perfeito travamento do tubo de qualquer material sem danificar a superfície do mesmo.
 The washer is made in stainless steel ensures the perfect tube clamping with every kinds of materials without damage the surface.

A conexão entre o tubo e a conexão assegura uma vedação total também em condições de impactos e vibrações
 The connection between the tube and the fitting ensure a total tightness even in severe conditions such as impact and vibrations.

A geometria particular da vedação permite a utilização da conexão também para aplicações com vácuo.
 The particular geometric shape of the seal ensure the perfect tightness even with vacuum.

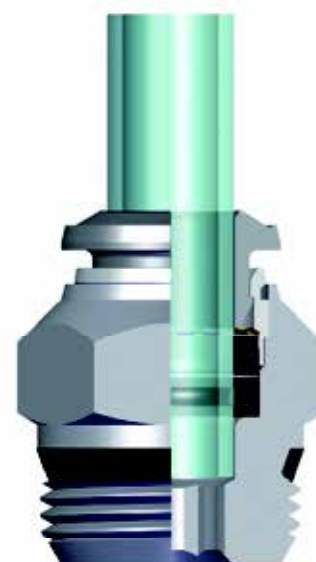

50000

CONEXÃO RETA COM ROSCA "SHORT" - STRAIGHT MALE ADAPTOR (SHORT)

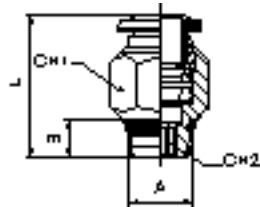

Código Code	Tubo Tube	A	B	L	CH1	CH2	Embal. Pack.
500000001	4	1/8	5.5	18	11	3	10
500000013	4	1/4	7	19	14	3	10
500000011	5	1/8	5.5	20	11	4	10
500000012	5	1/4	7	20	14	4	10
500000002	6	1/8	5.5	21.5	13	4	10
500000003	6	1/4	7	21	14	4	10
500000014	6	3/8	7.5	23	17	4	10
500000015	6	1/2	9	23.5	21	4	10
500000004	8	1/8	5.5	24.5	14	5	10
500000005	8	1/4	7	22	14	6	10
500000006	8	3/8	7.5	23	17	6	10
500000016	8	1/2	9	23.5	21	6	10
500000007	10	1/4	7	28	17	7	10
500000008	10	3/8	7.5	25.5	17	8	10
500000017	10	1/2	9	26	21	8	10
500000009	12	1/4	7	31.5	20	7	10
500000010	12	3/8	7.5	29.5	20	9	10
500000018	12	1/2	9	31.5	21	10	10
500000019	14	3/8	7.5	32.5	21	9	10
500000020	14	1/2	9	31.5	21	10	10

50010

CONEXÃO RETA COM SEXTAVADO INTERNO E ROSCA "SHORT" - STRAIGHT MALE ADAPTOR (SHORT) WITH EXAGON EMBEDDED

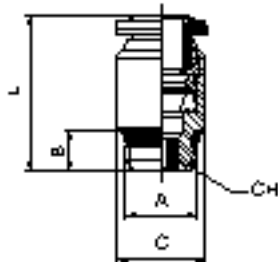

Código Code	Tubo Tube	A	B	C	L	CH	Embal. Pack.
5001000083	M5	4	8	19	2.5		10
5001000014	M5	4	9.5	19.5	2.5		10
5001000024	1/8	5.5	11	18	3		10
5001000094	M7x1	5	10	21	2.5		10
5001000076	M5	4	12	24.5	2.5		10
5001000036	1/8	5.5	12	21.5	4		10
5001000046	1/4	7	14	21	4		10
5001000058	1/8	5.5	14	25	5		10
5001000068	1/4	7	14	22.5	6		10

50020

CONEXÃO RETA COM ROSCA PARALELA - STRAIGHT MALE ADAPTOR (PARALLEL)

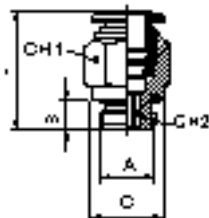

Código Code	Tubo Tube	A	B	C	L	CH1	CH2	Embal. Pack.
5002000021	3	M5	4	8	19	8	2	10
5002000001	4	M5	4	8	21	10	2	10
5002000002	4	1/8	6	13	20	10	3	10
5002000022	4	1/4	8	16	19.5	16	3	10
5002000018	5	M5	4	8	23.5	12	2	10
5002000019	5	1/8	6	13	22	12	4	10
5002000020	6	M5	4	10	24.5	13	2	10
5002000003	6	1/8	6	13	23.5	13	4	10
5002000004	6	1/4	8	16	23.5	13	4	10
5002000027	6	3/8	9	20	25	13	4	10
5002000028	6	1/2	10	25	27	13	4	10
5002000005	8	1/8	6	13	25	14	5	10
5002000006	8	1/4	8	16	23	14	6	10
5002000007	8	3/8	9	20	24	14	6	10
5002000029	8	1/2	10	25	26.5	14	6	10
5002000008	10	1/4	8	16	30.5	17	6	10
5002000009	10	3/8	9	20	27.5	17	8	10
5002000031	10	1/2	10	25	27	17	8	10
5002000032	12	1/4	8	16	34.5	20	6	10
5002000011	12	3/8	9	20	34	20	8	10
5002000023	12	1/2	10	25	31	22	10	10
5002000024	14	3/8	9	20	35	21	10	10
5002000025	14	1/2	10	25	32	22	10	10
5002000012	6	M12x1	8	15	23.5	13	4	10
5002000013	6	M12x1.25	8	15	23.5	13	4	10
5002000014	6	M12x1.5	8	15	23.5	13	4	10
5002000017	8	M12x1.5	8	15	27.5	14	6	10

50030

CONEXÃO RETA COM ROSCA FÊMEA - STRAIGHT FEMALE ADAPTOR

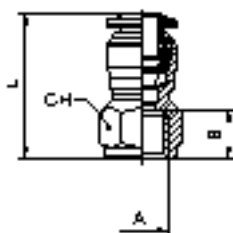

Código Code	Tubo Tube	A	B	L	CH	Embal. Pack.
500300007	3	M5	5.5	18.5	9	10
500300008	4	M5	5.5	21	11	10
500300001	4	1/8	8.5	24	13	10
500300009	4	1/4	11	27.5	16	10
500300006	5	1/8	8.5	26.5	13	10
500300002	6	1/8	8.5	26	13	10
500300003	6	1/4	11	29.5	16	10
500300004	8	1/8	8.5	27	15	10
500300005	8	1/4	11	29.5	17	10
500300010	8	3/8	12	32	19	10
500300011	10	1/4	11	32	18	10
500300012	10	3/8	12	33.5	19	10
500300013	10	1/2	15	39	24	10
500300014	12	3/8	12	36	21	10
500300015	12	1/2	15	41	24	10

50040

CONEXÃO RETA TUBO-TUBO - STRAIGHT CONNECTOR

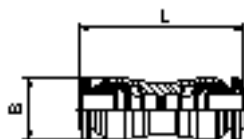

Código Code	Tubo Tube	L	B	Embal. Pack.	
500400009	3	26	8.5	10	
500400001	4	30.5	10.5	10	
500400008	5	33	11.5	10	
500400002	6	4	32	12.5	10
500400003	6	34	12.5	10	
500400004	8	6	35	14.5	10
500400005	8	36	14.5	10	
500400011	10	8	40.5	17.5	10
500400006	10	42	17.5	10	
500400012	12	10	45.5	20.5	10
500400007	12	47	20.5	10	
500400010	14	49	21.5	10	

50050

CONEXÃO PASSA-MURO RETA TUBO-TUBO - BULKHEAD CONNECTOR

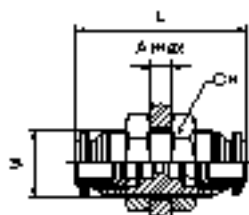

Código Code	Tubo Tube	M	L	CH	A _{max}	Embal. Pack.
500500007	3	M10x1	26	14	5	10
500500001	4	M12x1	31.5	17	7	10
500500006	5	M14x1	33	17	7	10
500500002	6	M14x1	35	17	9.5	10
500500003	8	M16x1	37	19	10.5	10
500500004	10	M20x1	43	24	12.5	10
500500005	12	M22x1	48	26	16.5	10

50100

CONEXÃO MACHO EM "L" COM ROSCA CÔNICA - ELBOW MALE ADAPTOR (TAPER)

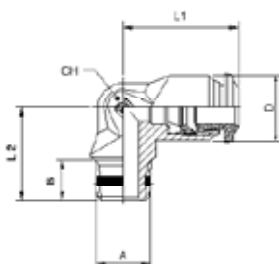

Código Code	Tubo Tube	A	B	L1	L2	CH	D	Embal. Pack.
501000001	4	M5	5	17	15	9	10	10
501000002	4	1/8	7.5	17	15.5	9	10	10
501000010	5	M5	5	20	17	11	12.5	10
501000011	5	1/8	7.5	20	17.5	11	12.5	10
501000003	6	1/8	7.5	21	17.5	11	12.5	10
501000012	6	1/4	11	21	21.5	11	12.5	10
501000004	8	1/8	7.5	22.5	19	13	14	10
501000005	8	1/4	11	22.5	21.5	13	14	10
501000006	10	1/4	11	26.5	24.5	16	17	10
501000007	10	3/8	11.5	26.5	24	16	17	10
501000008	12	1/4	11	30.5	28	19	21.5	10
501000009	12	3/8	11.5	30.5	28	19	21.5	10

50106

CONEXÃO EM "L" ORIENTÁVEL COM ROSCA FÊMEA - ORIENTING ELBOW FEMALE ADAPTOR

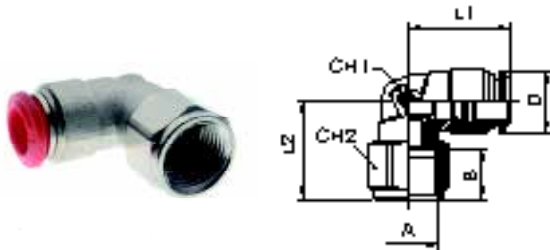

Código Code	Tubo Tube	A	B	L1	L2	CH1	CH2	D	Embal. Pack.	
501060001	4	-	1/8	8.5	18	20	9	13	10	10
501060002	4	-	1/4	11	18	21.5	9	16	10	10
501060003	6	-	1/8	8.5	21	20.5	11	13	12.5	10
501060004	6	-	1/4	11	21	23	11	16	12.5	10
501060005	8	-	1/8	8.5	22.5	22	12	13	14.5	10
501060006	8	-	1/4	11	22.5	24.5	12	16	14.5	10

50111

CONEXÃO MACHO EM "L" ORIENTÁVEL COM ROSCA SHORT - ORIENTING ELBOW MALE ADAPTOR (SHORT)

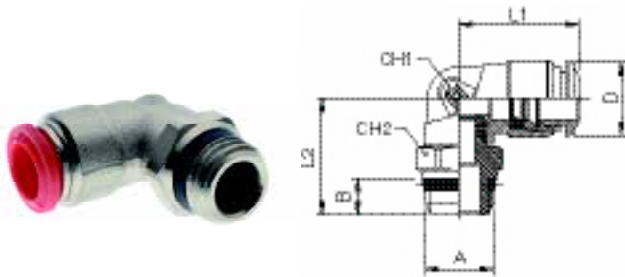

Código Code	Tubo Tube	A	B	L1	L2	CH	CH2	D	Embal. Pack.
501110001	4	1/8	5.5	18	19.5	9	13	10	10
501110002	4	1/4	7	18	21	9	15	10	10
501110003	5	1/8	5.5	20	21.5	11	13	12.5	10
501110004	6	1/8	5.5	21	21.5	11	13	12.5	10
501110005	6	1/4	7	21	23	11	15	12.5	10
501110006	8	1/8	5.5	22.5	24	12	13	14.5	10
501110007	8	1/4	7	22.5	24	12	15	14.5	10
501110008	8	3/8	7.5	22.5	24.5	12	17	14.5	10
501110009	8	1/2	9	22.5	27	12	21	14.5	10
501110010	10	1/4	7	26.5	26.5	14	16	17.5	10
501110011	10	3/8	7.5	26.5	24.5	14	17	17.5	10
501110012	10	1/2	9	26.5	27	14	21	17.5	10
501110013	12	3/8	7.5	31.5	26.5	16	20	21.5	10
501110014	12	1/2	9	31.5	29	16	21	21.5	10
501110015	14	3/8	7.5	31.5	27	16	20	21.5	10
501110016	14	1/2	9	31.5	29.5	16	21	21.5	10

50116

CONEXÃO MACHO EM "L" ORIENTÁVEL COM ROSCA PARALELA - ORIENTING ELBOW MALE ADAPTOR (PARALLEL)

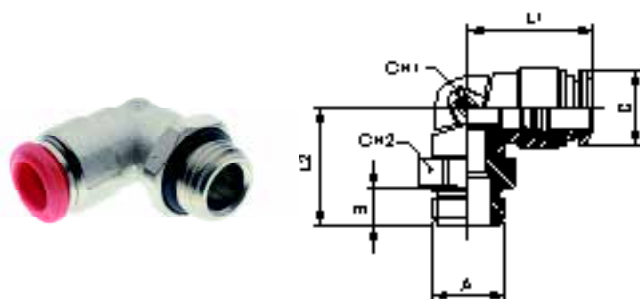

Código Code	Tubo Tube	A	B	L1	L2	CH1	CH2	D	Embal. Pack.
501160001	3	M5	3.5	16.5	17.5	9	8	10	10
501160002	4	M5	3.5	18	17.5	9	8	10	10
501160003	4	1/8	5.5	18	18	9	13	10	10
501160004	4	1/4	7	18	18	9	16	10	10
501160005	5	M5	3.5	20	20	11	11	12.5	10
501160006	5	1/8	5.5	20	20	11	13	12.5	10
501160007	6	M5	3.5	21	20	11	11	12.5	10
501160008	6	1/8	5.5	21	20	11	13	12.5	10
501160009	6	1/4	7	21	21.5	11	16	12.5	10
501160010	8	1/8	5.5	22.5	22.5	12	13	14.5	10
501160011	8	1/4	7	22.5	23	12	16	14.5	10
501160012	8	3/8	8	22.5	25	12	20	14.5	25
501160013	8	1/2	9.5	22.5	26.5	12	25	14.5	10
501160014	10	1/4	7	26.5	25.5	14	16	17.5	10
501160015	10	3/8	8	26.5	25	14	20	17.5	10
501160016	10	1/2	9.5	26.5	26.5	14	25	17.5	10
501160025	12	1/4	8	31.5	27.5	16	20	21.5	10
501160017	12	3/8	8	31.5	27	16	20	21.5	10
501160018	12	1/2	9.5	31.5	28.5	16	25	21.5	10
501160019	14	3/8	8	31.5	27.5	16	20	21.5	10
501160020	14	1/2	9.5	31.5	29	16	25	21.5	10
501160021	6	M12x1	7.5	20	22	11	16	12.5	10
501160022	6	M12x1.25	7.5	20	22	11	16	12.5	10
501160023	6	M12x1.5	7.5	20	22	11	16	12.5	10
501160024	8	M12x1.5	7.5	22.5	23.5	12	16	14.5	10

50121

CONEXÃO EM "L" PROLONGADO ORIENTÁVEL COM ROSCA MACHO SHORT - EXTENDED ORIENTING ELBOW MALE ADAPTOR (SHORT)

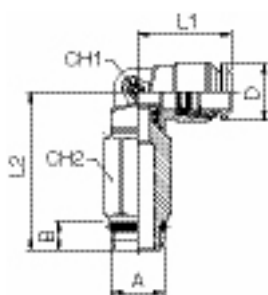

Código Code	Tubo Tube	A	B	L1	L2	CH1	CH2	D	Embal. Pack.
5012100001	4	1/8	5.5	18	31.5	9	12	10	10
5012100002	4	1/4	7	18	33	9	15	10	10
5012100003	5	1/8	5.5	20	36	11	12	12.5	10
5012100004	6	1/8	5.5	21	36	11	12	12.5	10
5012100005	6	1/4	7	21	37.5	11	15	12.5	10
5012100006	8	1/8	5.5	22.5	40.5	12	12	14.5	10
5012100007	8	1/4	7	22.5	40.5	12	15	14.5	10
5012100008	8	3/8	7.5	22.5	41	12	16	14.5	10
5012100009	10	1/4	7	26.5	46	14	15	17.5	10
5012100010	10	3/8	7.5	26.5	44	14	17	17.5	10

50126

CONEXÃO EM "L" PROLONGADO ORIENTÁVEL COM ROSCA MACHO PARALELA - EXTENDED ORIENTING ELBOW MALE ADAPTOR (PARALLEL)

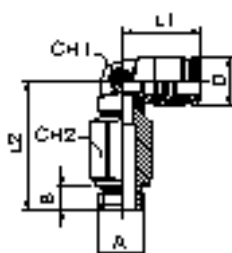

Código Code	Tubo Tube	A	B	L1	L2	CH1	CH2	D	Embal. Pack.
5012600001	4	1/8	5.5	18	30	9	12	10	10
5012600002	4	1/4	7	18	32	9	15	10	10
5012600003	5	1/8	5.5	20	34.5	11	12	12.5	10
5012600004	6	1/8	5.5	21	34.5	11	12	12.5	10
5012600005	6	1/4	7	21	36	11	15	12.5	10
5012600006	8	1/8	5	23	39	12	12	14.5	10
5012600007	8	1/4	7	22.5	39.5	12	15	14.5	10
5012600008	8	3/8	8	22.5	41.5	12	18	14.5	10
5012600009	10	1/4	7	26.5	45	14	16	17.5	10
5012600010	10	3/8	8	26.5	44.5	14	18	17.5	10

50130

CONEXÃO EM "L" TUBO-TUBO - ELBOW CONNECTOR

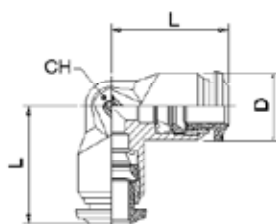

Código Code	Tubo Tube	L	CH	D	Embal. Pack.
5013000007	3	17	9	10	10
5013000001	4	17	9	10	10
5013000006	5	20	11	12.5	10
5013000002	6	21	11	12.5	10
5013000003	8	22.5	13	14	10
5013000004	10	26.5	16	17	10
5013000005	12	30.5	19	21.5	10
5013000008	14	32.5	19	21.5	10

50200

CONEXÃO EM "T" CENTRAL COM ROSCA MACHO CÔNICA - TEE MALE ADAPTOR (TAPER) - CENTRE LEG

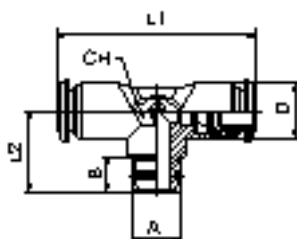

Código Code	Tubo Tube	A	B	L1	L2	CH	D	Embal. Pack.
5020000001	4 - M5	5	34	15	9	10	10	10
5020000002	4 - 1/8	7.5	34	15.5	9	10	10	10
5020000010	5 - 1/8	7.5	40	17.5	11	12.5	10	10
5020000003	6 - 1/8	7.5	42	17.5	11	12.5	10	10
5020000004	8 - 1/8	7.5	45	19	13	14	10	10
5020000005	8 - 1/4	11	45	21.5	13	14	10	10
5020000006	10 - 1/4	11	53	24.5	16	17	10	10
5020000007	10 - 3/8	11.5	53	24	16	17	10	10
5020000008	12 - 1/4	11	61	28	19	21.5	10	10
5020000009	12 - 3/8	11.5	61	28	19	21.5	10	10

50211

CONEXÃO EM "T" CENTRAL ORIENTÁVEL COM ROSCA MACHO SHORT - ORIENTING TEE MALE ADAPTOR (SHORT) - CENTRE LEG

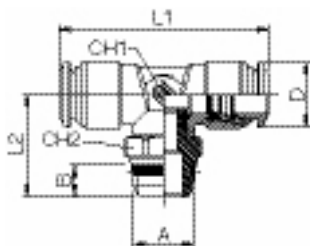

Código Code	Tubo Tube	A	B	L1	L2	CH1	CH2	D	Embal. Pack.
5021100001	4	1/8	5.5	34	20	9	13	10	10
5021100002	4	1/4	7	34	21.5	9	15	10	10
5021100003	5	1/8	5.5	40	22	11	13	12.5	10
5021100004	6	1/8	5.5	42	22	11	13	12.5	10
5021100005	6	1/4	7	42	23.5	11	15	12.5	10
5021100006	8	1/8	5.5	45	25.5	13	13	14.5	10
5021100007	8	1/4	7	45	25.5	13	15	14.5	10
5021100008	8	3/8	7.5	45	26	13	17	14.5	10
5021100009	8	1/2	9	45	28.5	13	21	14.5	10
5021100010	10	1/4	7	53	29	14	16	17.5	10
5021100011	10	3/8	7.5	53	27	14	17	17.5	10
5021100012	10	1/2	9	53	29.5	14	21	17.5	10
5021100013	12	3/8	7.5	62.6	29.5	16	20	21.5	10
5021100014	12	1/2	9	62.6	32	16	21	21.5	10
5021100015	14	3/8	7.5	62.6	29.5	16	20	21.5	10
5021100016	14	1/2	9	62.6	32	16	21	21.5	10

50216

CONEXÃO EM "T" CENTRAL ORIENTÁVEL COM ROSCA MACHO PARALELA - ORIENTING TEE MALE ADAPTOR (PARALLEL) - CENTRE LEG

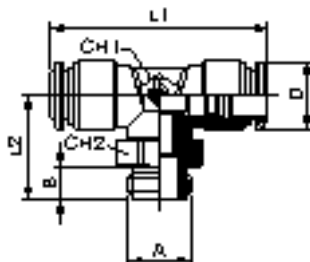

Código Code	Tubo Tube	A	B	L1	L2	CH1	CH2	D	Embal. Pack.
5021600001	3	M5	3.5	33	17	9	8	10	10
5021600002	4	M5	3.5	34	18	9	8	10	10
5021600003	4	1/8	5.5	34	18.5	9	13	10	10
5021600004	4	1/4	7	34	20	9	16	10	10
5021600005	5	M5	3.5	40	20.5	11	11	12.5	10
5021600006	5	1/8	5.5	40	20.5	11	13	12.5	10
5021600007	6	M5	3.5	42	20.5	11	11	12.5	10
5021600008	6	1/8	5.5	42	20.5	11	13	12.5	10
5021600009	6	1/4	7	42	22	11	16	12.5	10
5021600010	8	1/8	5.5	45	23.5	13	13	14.5	10
5021600011	8	1/4	7	45	24	13	16	14.5	10
5021600012	8	3/8	8	45	26	13	20	14.5	10
5021600013	8	1/2	9.5	45	27.5	13	25	14.5	10
5021600014	10	1/4	7	53	27.5	14	16	17.5	10
5021600015	10	3/8	8	53	27	14	20	17.5	10
5021600016	10	1/2	9.5	53	28.5	14	25	17.5	10
5021600017	12	3/8	8	62.5	29.5	16	20	21.5	10
5021600018	12	1/2	9.5	62.5	31	16	25	21.5	10
5021600019	14	3/8	8	62.5	29.5	16	20	21.5	10
5021600020	14	1/2	9.5	62.5	31	16	25	21.5	10
5021600021	6	M12x1	7.5	42	22	11	16	12.5	10
5021600022	6	M12x1.25	7.5	42	22	11	16	12.5	10
5021600023	6	M12x1.5	7.5	42	22	11	16	12.5	10

50223

CONEXÃO EM "T" LATERAL ORIENTÁVEL COM ROSCA MACHO SHORT - ORIENTING TEE MALE ADAPTOR (SHORT) OFF - SET LEG

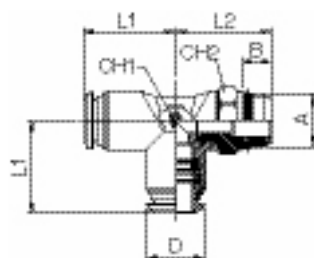

Código Code	Tubo Tube	A	B	L1	L2	CH1	CH2	D	Embal. Pack.
5022300001	4	1/8	5.5	17	20	9	13	10	10
5022300002	4	1/4	7	17	21.5	9	15	10	10
5022300003	5	1/8	5.5	20	22	11	13	12.5	10
5022300004	6	1/8	5.5	21	22	11	13	12.5	10
5022300005	6	1/4	7	21	23.5	11	15	12.5	10
5022300006	8	1/8	5.5	22.5	25	13	13	14.5	10
5022300007	8	1/4	7	22.5	25	13	15	14.5	10
5022300008	8	3/8	7.5	22.5	28	13	17	14.5	10
5022300009	8	1/2	9	22.5	28	13	21	14.5	10
5022300010	10	1/4	7	26.5	26	14	16	17.5	10
5022300011	10	3/8	7.5	26.5	26	14	17	17.5	10
5022300012	10	1/2	9	26.5	28.5	14	21	17.5	10
5022300013	12	3/8	7.5	31.5	29.5	16	20	21.5	10
5022300014	12	1/2	9	31.5	32	16	21	21.5	10

50226

CONEXÃO EM "T" LATERAL ORIENTÁVEL COM ROSCA MACHO PARALELA - ORIENTING TEE MALE ADAPTOR (PARALLEL) OFF - SET LEG

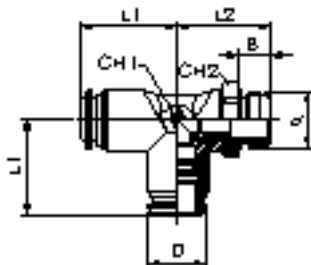

Código Code	Tubo Tube	A	B	L1	L2	CH1	CH2	D	Embal. Pack.
5022600001	3	M5	3.5	16.5	17	9	8	10	10
5022600002	4	M5	3.5	17	18	9	8	10	10
5022600003	4	1/8	5.5	17	18.5	9	13	10	10
5022600004	4	1/4	7	17	20	9	16	10	10
5022600005	5	M5	3.5	20	20.5	11	11	12.5	10
5022600006	5	1/8	5.5	20	20.5	11	13	12.5	10
5022600007	6	M5	3.5	21	20.5	11	11	12.5	10
5022600008	6	1/8	5.5	21	20.5	11	13	12.5	10
5022600009	6	1/4	7	21	22	11	16	12.5	10
5022600010	8	1/8	5.5	22.5	22.5	13	13	14.5	10
5022600011	8	1/4	7	22.5	24	13	16	14.5	10
5022600012	8	3/8	8	22.5	26	13	20	14.5	10
5022600013	8	1/2	9.5	22.5	27.5	13	25	14.5	10
5022600014	10	1/4	7	26.5	27	14	16	17.5	10
5022600015	10	3/8	8	26.5	26.5	14	20	17.5	10
5022600016	10	1/2	9.5	26.5	28	14	25	17.5	10
5022600017	12	3/8	8	31.5	29.5	16	20	21.5	10
5022600018	12	1/2	9.5	31.5	31	16	25	21.5	10
5022600021	6	M12x1	7.5	21	22	11	16	12.5	10
5022600022	6	M12x1.25	7.5	21	22	11	16	12.5	10
5022600023	6	M12x1.5	7.5	21	22	11	16	12.5	10

50230

CONEXÃO EM "T" TUBO-TUBO - TEE CONNECTOR

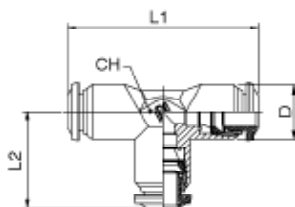

Código Code	Tubo Tube	L1	L2	CH	D	Embal. Pack.
5023000007	3	34	17	9	10	10
5023000001	4	34	17	9	10	10
5023000006	5	40	20	11	12.5	10
5023000002	6	42	21	11	12.5	10
5023000003	8	45	22.5	13	14	10
5023000004	10	53	26.5	16	17	10
5023000005	12	61	30.5	19	21.5	10
5023000008	14	65.5	32.5	19	21.5	10

50310

CONEXÃO EM "Y" TUBO-TUBO - Y CONNECTOR

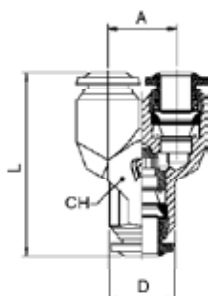

Código Code	Tubo Tube	A	L	CH	D	Embal. Pack.
5031000007	3	10	29	11	10	10
5031000001	4	11	32	11	10	10
5031000004	5	13.5	35	13	12.5	10
5031000002	6	13.5	36.5	13	12.5	10
5031000003	8	15.5	41	15	14	10
5031000008	10	18.5	48	18	17	10

50500

ANEL ORIENTÁVEL EM "L" - SINGLE BANJO BODY

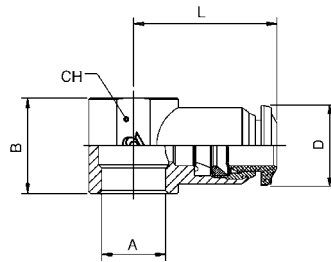

Código Code	Tubo Tube	A	B	L	CH	D	Embal. Pack.
505000019	3	M5	12.5	19	-	10	10
505000020	3	M6	12.5	19	-	10	10
505000001	4	M5	12.5	19	-	10	10
505000002	4	M6	12.5	19	-	10	10
505000003	4	1/8	15	21	14	10	10
505000013	5	M5	12.5	20	-	12.5	10
505000017	5	M6	12.5	20	-	12.5	10
505000014	5	1/8	15	21.5	14	12.5	10
505000015	5	1/4	17	24.5	18	12.5	10
505000016	6	M5	12.5	20.5	-	12.5	10
505000018	6	M6	12.5	20.5	-	12.5	10
505000004	6	1/8	15	22	14	12.5	10
505000005	6	1/4	17	25	18	12.5	10
505000006	8	1/8	15	24	14	14	10
505000007	8	1/4	17	26	18	14	10
505000008	8	3/8	20	28	21	14	10
505000009	10	1/4	17	29	18	17	10
505000010	10	3/8	20	30.5	21	17	10
505000012	12	3/8	20	32.5	21	21.5	10
505000021	12	1/2	24	35	25	21.5	10
505000022	14	1/2	24	35.5	25	21.5	10

50510

ANEL ORIENTÁVEL EM "T" - DOUBLE BANJO BODY

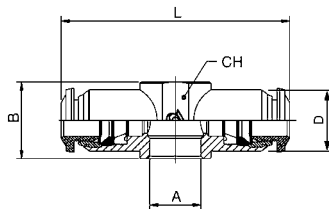

Código Code	Tubo Tube	A	B	L	CH	D	Embal. Pack.
505100001	4	M5	12.5	38	-	10	10
505100002	4	M6	12.5	38	-	10	10
505100003	4	1/8	15	42	14	10	10
505100008	5	1/8	15	43	14	12.5	10
505100009	5	1/4	17	49	18	12.5	10
505100004	6	1/8	15	44	14	12.5	10
505100005	6	1/4	17	50	18	12.5	10
505100006	8	1/8	15	48	14	14	10
505100007	8	1/4	17	52	18	14	10

50550

CONEXÃO TIPO BANJO EM "L" - ORIENTING SINGLE BANJO BODY MALE

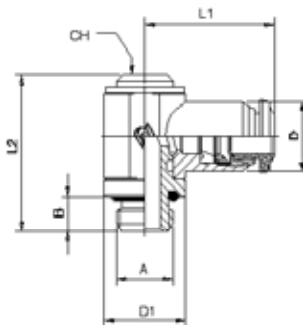

Código Code	Tubo Tube	A	B	L1	L2	CH	D1	D	Embal. Pack.
505500001	4	M5	3.6	19	24.5	-	CH8	10	10
505500002	4	1/8	6	21	28	5	14	10	10
505500012	5	M5	3.6	20	24.5	-	CH8	12.5	10
505500013	5	1/8	6	21.5	28	5	14	12.5	10
505500014	5	1/4	8	24.5	31	6	18	12.5	10
505500015	6	M5	3.6	20.5	24.5	-	CH8	12.5	10
505500003	6	1/8	6	22.5	28	5	14	12.5	10
505500004	6	1/4	8	25	31	6	18	12.5	10
505500005	8	1/8	6	24	28	5	14	14	10
505500006	8	1/4	8	26	31	6	18	14	10
505500007	8	3/8	9	28	35.5	7	21	14	10
505500008	10	1/4	8	29	31	6	18	17	10
505500009	10	3/8	9	30.5	35.5	7	21	17	10
505500011	12	3/8	9	32.5	35.5	7	21	21.5	10

50560

CONEXÃO TIPO BANJO EM "T" - ORIENTING DOUBLE BANJO BODY MALE

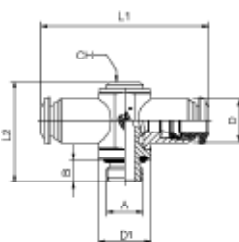

Código Code	Tubo Tube	A	B	L1	L2	D1	CH	D	Embal. Pack.
505600002	4	1/8	6	42	27	14	5	10	10
505600008	5	1/8	6	43	27	14	5	12.5	10
505600009	5	1/4	8	49	31	18	6	12.5	10
505600003	6	1/8	6	45	27	14	5	12.5	10
505600004	6	1/4	8	50	31	18	6	12.5	10
505600005	8	1/8	6	48	27	14	5	14	10
505600006	8	1/4	8	52	31	18	6	14	10

51410

HASTE PARA CONEXÃO BANJO COM 1 CAVIDADE - BANJO STEM SINGLE

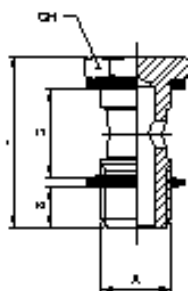

Código Code	A	B	C	L	CH	Embal. Pack.
5141000011	M5	4	12.5	22	8	25
5141000012	M6	5	12.5	23	8	25
5141000013	1/8	6	15	28	14	25
5141000014	1/4	8	17	32	17	25
5141000015	3/8	9	20	36	19	25
5141000016	1/2	10	24	42	24	25
5141000017	*M12x1.58	17	32	17		25

ESTE ITEM VEM ACOMPANHADO DE ARRUELAS EM PA66 (CÓD. 1610).
THIS ITEM WILL BE SUPPLIED WITH THE PA66 WASHERS (ART. 1610).

*COM ESTA HASTE PARA BANJO UTILIZAR OS ANÉIS ORIENTÁVEIS DE 1/4.
*WITH THIS BANJO STEM USING 1/4 ORIENTING BANJO BODY.

51420

HASTE PARA CONEXÃO BANJO COM 2 CAVIDADES - BANJO STEM DOUBLE

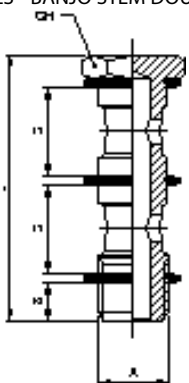

Código Code	A	B	C	L	CH	Embal. Pack.
5142000011	1/8	6	15	44.5	14	25
5142000012	1/4	8	17	50.5	17	25
5142000013	3/8	9	20	58	19	25
5142000014	1/2	10	24	68	24	25
5142000015	*M12x1.5	8	17	50.5	17	25

ESTE ITEM VEM ACOMPANHADO DE ARRUELAS EM PA66 (CÓD. 1610).
THIS ITEM WILL BE SUPPLIED WITH THE PA66 WASHERS (ART. 1610).

*COM ESTA HASTE PARA BANJO UTILIZAR OS ANÉIS ORIENTÁVEIS DE 1/4.
*WITH THIS BANJO STEM USING 1/4 ORIENTING BANJO BODY.

51430

HASTE PARA CONEXÃO BANJO COM 3 CAVIDADES - BANJO STEM TRIPLE

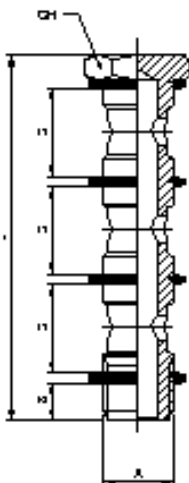

Código Code	A	B	C	L	CH	Embal. Pack.
5143000011	1/8	6	15	61	14	25
5143000012	1/4	8	17	69	17	25
5143000013	3/8	9	20	80	19	25
5143000014	1/2	10	24	94	24	10

ESTE ITEM VEM ACOMPANHADO DE ARRUELAS EM PA66 (CÓD. 1610).
THIS ITEM WILL BE SUPPLIED WITH THE PA66 WASHERS (ART. 1610).

51440

HASTE PARA CONEXÃO BANJO COM 1 CAVIDADE MACHO - FÊMEA - FEMALE BANJO STEM SINGLE

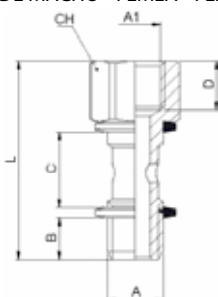

Código Code	A	A1	B	C	D	L	CH	Embal. Pack.
5144000001	1/8	1/8	6	15	8.5	34.5	14	25
5144000002	1/4	1/4	8	17	11	40.5	17	25
5144000003	3/8	3/8	9	20	12	45.5	19	25

ESTE ITEM VEM ACOMPANHADO DE ARRUELAS EM PA66 (CÓD. 1610).
THIS ITEM WILL BE SUPPLIED WITH THE PA66 WASHERS (ART. 1610).

50600

ADAPTADOR MACHO COM ROSCA PARALELA - MALE ADAPTOR PARALLEL

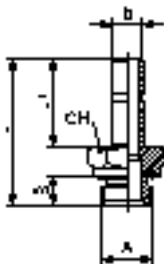

Código Code	D	A	B	L	L1	CH	Embal. Pack.
5060000001	4	M5	4	24	15	8	10
5060000002	4	1/8	6	26.5	15	13	10
5060000012	5	M5	4	26	17	8	10
5060000013	5	1/8	6	28.5	17	13	10
5060000014	5	1/4	8	31	17	16	10
5060000015	6	M5	4	26	17	8	10
5060000003	6	1/8	6	28.5	17	13	10
5060000004	6	1/4	8	31	17	16	10
5060000005	8	1/8	6	29.5	18	13	10
5060000006	8	1/4	8	32	18	16	10
5060000007	8	3/8	9	33.5	18	20	10
5060000016	10	1/8	6	33.5	22	13	10
5060000008	10	1/4	8	36	22	16	10
5060000009	10	3/8	9	37.5	22	20	10
5060000010	12	1/4	8	38.5	24.5	16	10
5060000011	12	3/8	9	40	24.5	20	10

8610

TAMPÃO EM POLIAMIDA - POLYAMIDE PLUG

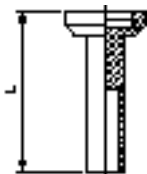

Código Code	Tubo Tube	L	Embal. Pack.
086100031X0RO	3	18	25
086100031X1RO	4	23.5	25
086100031X3RO	5	24.5	25
086100031X4RO	6	24.5	25
086100031X7RO	8	26	25
086100031X9RO	10	28.5	25
086100031Y1RO	12	28.5	25
086100031Y3RO	14	28.5	20

50625

JUNÇÃO DUPLA - DOUBLE JOINT

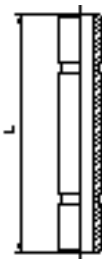

Código Code	Tubo Tube	L	Embal. Pack.
506250001X1NB	4	31	10
506250001X3NB	5	33	10
506250001X4NB	6	34	10
506250001X7NB	8	36	10
506250001X9NB	10	45	10
506250001Y1NB	12	50	10

50700

REDUÇÃO - REDUCER



Código Code	A	B	L	D	Embal. Pack.
5070000006	4	3	30	8.5	10
5070000004	5	4	32	11.5	10
5070000001	6	4	30	10.5	10
5070000005	6	5	34.5	11.5	10
5070000008	8	4	32.5	10.5	10
5070000002	8	6	34.5	12.5	10
5070000009	10	4	31.5	10.5	10
5070000003	10	8	38.5	14.5	10
5070000007	12	8	39.5	14.5	10
5070000010	12	10	43	17.5	10

55800R

CARTUCHO DE COMPRESSÃO - PUSH-FIT CARTRIDGES

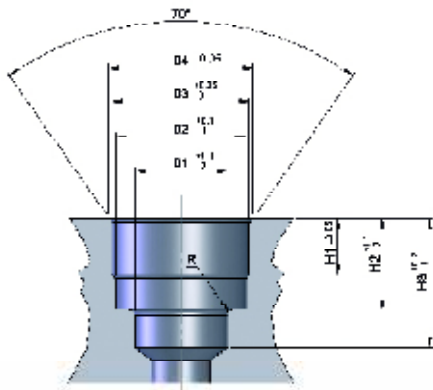
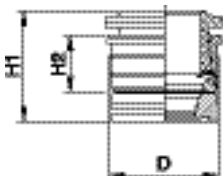

Código Code	Tubo Tube	D	H1	H2	Embal. Pack.
558000008	3	6.7	9	5	25
558000001	4	8.7	10.4	5.6	25
558000002	5	9.75	11.8	6.3	25
558000003	6	10.75	12.4	6.9	25
558000004	8	12.7	12.4	6.9	25
558000005	10	15.7	15.7	8.5	25
558000006	12	18.3	17.8	9.5	25

55800

SEDE - SEAT

 DIMENSÃO DA SEDE DO CARTUCHO DE COMPRESSÃO
 SEATS DIMENSIONS PUSH-FIT CARTRIDGES

Tubo Tube	D1	D2	D3	D4	H1	H2	H3	R
3	3.4	6.05	6.4	6.95	3.7	6.1	8.6	0.5
4	4.2	7.45	8.4	9	3.75	6.5	9.5	0.5
5	5.2	8.35	9.4	10.15	4.45	7.9	10.5	0.5
6	6.2	9.35	10.45	11.35	5	8.5	11.5	0.5
8	8.2	11.4	12.4	12.9	5.2	8.5	12.5	0.75
10	10.2	14.5	15.4	16	6.7	10.5	15	0.75
12	12.2	17	18	19	7.5	12.1	17	1

55801

 FRESA PARA FURAÇÃO DA SEDE DO CARTUCHO DE COMPRESSÃO
 TOOL FOR PUSH-FIT CARTRIDGES SEAT

Código Code	Tubo Tube	ø Corpo ø Body	Embal. Pack.
558010007	3	10	1
558010001	4	10	1
558010006	5	12	1
558010002	6	12	1
558010003	8	12	1
558010004	10	16	1
558010005	12	16	1

55802

 TUBETE PARA MONTAGEM DO CARTUCHO DE COMPRESSÃO
 ASSEMBLING TOOL FOR PUSH-FIT CARTRIDGES



Código Code	Tubo Tube	Embal. Pack.
558020001	3	1
558020002	4	1
558020003	5	1
558020004	6	1
558020005	8	1
558020006	10	1
558020007	12	1

INSTRUÇÕES DE MONTAGEM DO CARTUCHO DE COMPRESSÃO CÓD. 55800R PUSH-FIT CARTRIDGES ASSEMBLING INSTRUCTIONS ART. 55800R

Realize a furação da sede para o cartucho utilizando a fresa de cód.55801
 Make the seat for the cartridge utilizing the suitable tool Art. 55801

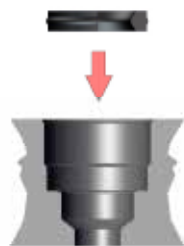

2



Insira a vedação no fundo da sede.
 Insert the lip inside of the seat.

Insira o cartucho no tubete de montagem Cód.55802
 Insert the cartridge into the assembling tool Art. 55802

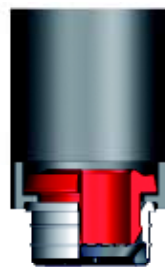

3

4



Pressione o cartucho no interior da sede até tocar a superfície de montagem com o tubete.
 Press the cartridge inside of the seat until it will be reached the abutment surface with the assembling tool.

50900

DISTRIBUIDOR EM ALUMÍNIO DE 5 VIAS - ALUMINIUM MANIFOLD 5 WAYS

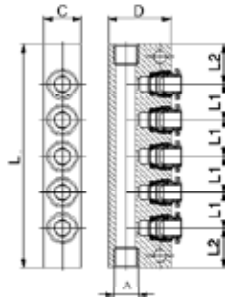

Código Code	Tubo Tube	A	C	D	L	L1	L2	Embal. Pack.
5090000001	4	1/8	15	25	75	12	13.5	5
5090000002	6	1/8	15	25	90	14.5	16	5
5090000003	6	1/4	20	30	90	14.5	16	5
5090000004	8	1/4	20	30	100	16	18	5

50990

FERRAMENTA PARA DESMONTAGEM - TOOL FOR DISASSEMBLING

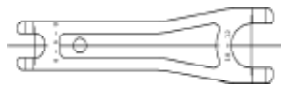

Código Code	Embal. Pack.
5099000001	10

50006

ANEL DE VEDAÇÃO PARA ROSCAS CÔNICAS - THREAD PACKING FOR TAPER THREADS



Código Code	Rosca Thread	Embal. Pack.
5000600240200	1/8	10
5000600240300	1/4	10
5000600240400	3/8	10
5000600240500	1/2	10

